

**INSTALLATION AND USE OF THE**  
**JETSLIDE G2 from CANDOCK**

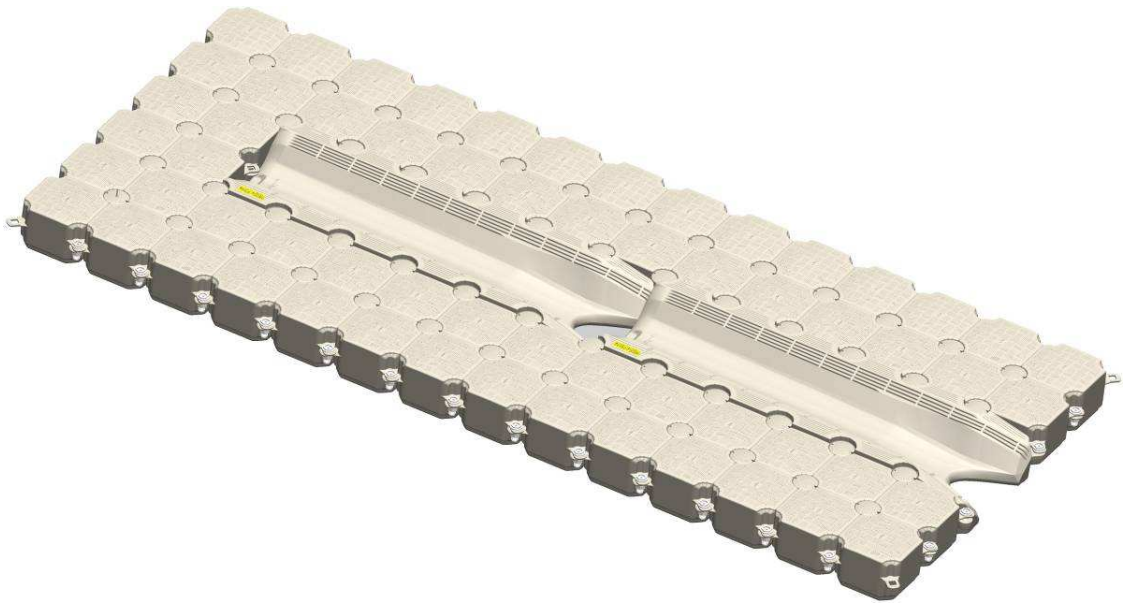

Here are some very important details concerning the installation of JetSlide systems for PWC and boats:

**INSTRUCTIONS FOLLOWING ARE GUIDELINES TO BE FOLLOWED AND RESPECTED. CANDOCK ASSUMES NO RESPONSIBILITY FOR DAMAGES INCURRED BY THE NON-COMPLIANCE WITH THESE GUIDELINES.**

All distributors are held responsible for giving training to the customers on the complete use of the system, theoretical and practical with the watercraft of the customer. Candock Inc. will not be held responsible for all damages resulting from the fact that the operator did not receive the adequate training.

With the numerous varieties of boats on the market, it is possible that certain types will not be compatible with our system. Candock Inc. cannot be held responsible for this fact. It is impossible for us to be able to test all the existing types of boats in the world. We can on the other hand confirm that all the boats having stabilizing fins and/or a driveshaft passing through the hull are not compatible, such as the majority of ski and wake board boats.

Never use the JetSlide without Candock cubes around.

**Orientation :**

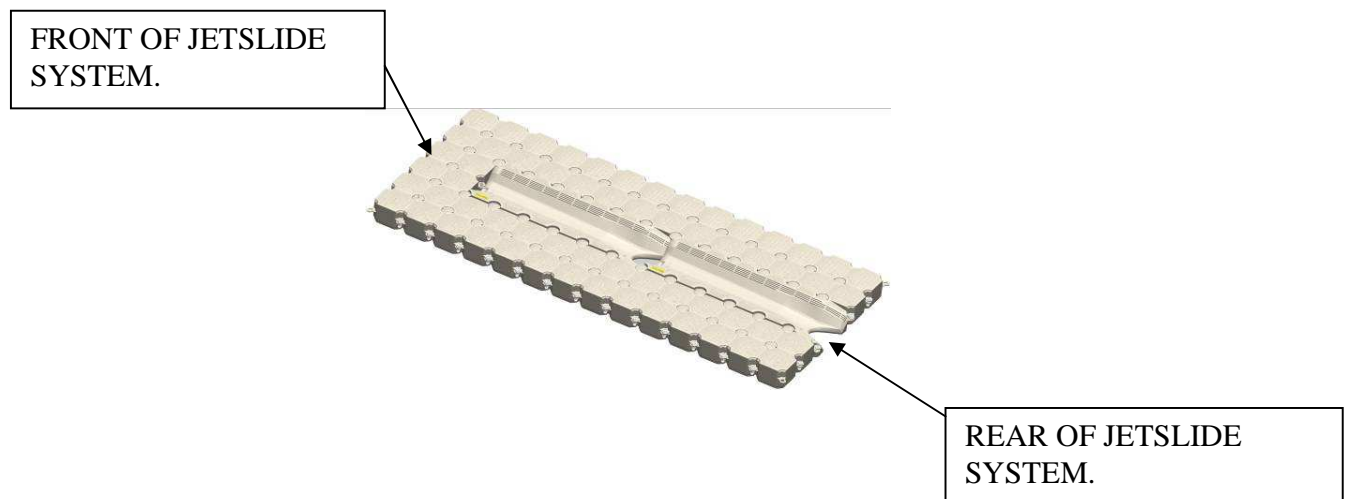

## I) INSTALLATION & USE OF THE *JETSLIDE*

### 1) ASSEMBLY

#### Advices :

- Assemble on a flat surface rather than water. It will be easier that way.
- Assemble the cubes around the JetSlide. If you attach it to a dock, make sure the plugs are facing the shore. If your JetSlide is an independent unit, black plugs must be oriented toward the front of your unit.



#### Steps : See ANNEXE A

- 1) Insert spacers before screwing the connecting pins. When the cubes are put together, the tabs (**See B**) will nest on top of each other (**See C**). The tabs are numbered (**See D**), one (1) being the lowest and four (4) the highest. The JetSlide's tabs are placed just below the #1 tab of the cubes. You must insert spacers at the right positions to generate the equivalent of four (4) tabs on top of the Jetslide's tabs (**See E, F**).
- 2) Insert spacers as you position cubes around JetSlide.
- 3) Insert connecting pins around the JetSlide and make a slight hand tightening, then tighten them with the T key until they are snug (**See H**).
- 4) In position 1 (**See I**) connecting pin require a sliding nut because the JetSlide has no tab for this position. Place a sliding nut on the lower tab (1).
- 5) Install the exterior lug connectors and screw them around the JetSlide using the proper tool for this purpose (**See G**). You will never have more than two (2) tabs or more than two (2) spacers to install.

Normally, in the case of a personal water craft, the cubes are positioned rearmost of JetSlide are not necessary, but if a higher flotation is required, you can add cubes or corner cubes (therefore using JetSlide bolts to fix the modules on the last JetSlide tab. You will also need spacers).

## 2) ANCHOR

### Steps : See ANNEXE B

- 1) The JetSlide can simply be attached to an existing dock using rope or a custom made bracket (ask your dealer). If you tie the JetSlide to an existing dock, make sure that the dock is sturdy enough to resist the forward and backward movement generated by the watercraft when it enters or goes down the JetSlide.
- 2) The JetSlide can be added to an existing Candock dock. Make sure that the dock is anchored well enough to resist the forward and backward movement generated by the watercraft when it enters or goes down the JetSlide.
- 3) The JetSlide can also be installed by using (two) 2 or (four) 4 pilings (**See K**). Please note that an installation with 4 piles is not recommended for PWC's. If the system is for a boat, the piles at the back should not be placed in the perimeter covered by the JetSlide at the back, this could limit its capacity to lower (sink) and will make going on and off the system more difficult. Ask your dealer for appropriate parts and instructions. This type of installation should not be used when water depth is more than 2m / 6'.
- 4) The JetSlide can be anchored by using weights and chains (**See L**). It is very important that the chains stay as tight as possible. Ask your dealer for recommended weight of anchors and special attachments. You will have to use galvanized or stainless steel 5/16" chain or good quality marine rope, the length will depend on water depth and variations of the water level. When using this type of installation, it is normal that the JetSlide moves slightly forward when entering the unit and backwards when exiting the unit. This is why you need to check regularly the tightness of the chains to limit this movement.

### 3) USING THE JETSLIDE

- 1) Approach the JetSlide at idle, keeping the craft straight and centred with the JetSlide. When the bow of the craft will be in contact with the JetSlide, give small throttle strokes that will make the craft align with the JetSlide. When the craft is in line with the JetSlide, throttle in slowly. After a few tries, you will rapidly develop a feel of how much you have to use the throttle to reach final position on the JetSlide
- 2) For a boat, engine must be trimmed down fully during the entering procedures and the depth of water at the back of the system must be 3' /1m minimum at all time to avoid damage to the boat. Increase throttle power until the boat is fully up on the system. When the engine gets in contact with the JetSlide, you will feel the craft stopping. You must immediately throttle down. This indicates that the craft is at final resting position. Entering the unit at high speed may damage the unit. We recommend, at first, that you try at slow speeds until you reach the correct speed. If the boat gets on the system but is not all the way in, you can continue throttling progressively until the boat reaches final resting position. **Be careful, boarding at high speed can be dangerous.**
- 3) **It is recommended to secure the craft to a cleat in order to prevent the craft from sliding back into the water accidentally.** The craft can be locked to the JetSlide with a chain when you are not using it. Ask your dealer for details.
- 4) To go back into the water, take a standing position on your PWC and generate a backward movement by using your lower back and arms, pumping backwards rapidly until the PWC starts sliding back into the water. The procedure is easier when the PWC is wet. You can also stand up at the back of your PWC, grab the handle of the seat and transfer your weight back. The easiest way to return to water is to keep the front of the PWC in one hand and the handle of the other and then push gently. Be vigilant, because at some point, your PWC will start to go down by itself. At this point, you will have to get on it if you do not want your watercraft in the water without you.
- 5) For a boat, put the engine in reverse and increase throttle until craft starts to go down by itself. It helps if you wet the system, especially if the boat was not used for a couple of days. It might be necessary to give a good throttle stroke to start the movement and then

throttle down. For a Jet boat, the pneumatic assisted system will be required, no matter the weight of the boat.

## II) WARNINGS & SPECIAL INSTRUCTIONS

- 1) Like all JetSlide installations, the system should not be installed in areas subject to waves of more than 0.75m / 2ft regularly. We recommend an installation in a protected area.
- 2) The installation of multiple JetSlides side to side is possible, but a minimum of 2 rows of cubes must be found between each JetSlide. **An installation with only one row is possible, but the risk of damage is possible and the resulting damage will not be covered by the warranty. Contact Candock for more information.**
- 3) The handling of several JetSlides assembled in series by lifting (for winterizing by using a crane for example) is strictly forbidden. **The excessive inflections will break the tabs of the JetSlide and the resulting damage will not be covered by the warranty. Contact Candock for more information.**
- 4) The depth of water at the back of the system must be 1m / 3' minimum at all time to avoid damage to the boats.
- 5) Riveted hulls can damage the JetSlide.
- 6) Surface can be slippery when the system is wet.
- 7) The capacity of the JetSlide may change depending on the type of assembly, accessories and according to the weight distribution of the engines.
- 8) Please note that some boats have cooling intakes for the engine which is on the hull and this intake needs to be in the water when the engine is running. Please make sure that if you are doing a JetSlide system that this intake will be in the water when the engine



is running. **CANDOCK INC. WILL NOT TAKE ANY RESPONSABILITY FOR ANY TYPE OF DAMAGE TO A BOAT RESULTING FROM THIS. IT IS THE RESPONSABILITY OF THE DISTRIBUTOR TO MAKE SURE THAT THIS IS VERIFIED BEFORE SELLING THE INSTALLATION TO THE CLIENT.** We recommend that you inform your clients of that even if you are sure that the intake will be in the water.

- 9) The fact of removing cubes at the back of the system to lower the back of the system closer to the water could exert excessive pressure on the back tabs of the Jetslide and **may cause damage which will not be covered by the warranty.**
- 10) **All distributors are held responsible for giving training to the customers on the complete use of the system, theoretical and practical with the watercraft of the customer. Candock Inc. will not be held responsible for all damage resulting from the fact that the operator did not receive the adequate training.**
- 11) The boats and personal water crafts must be completely mounted on the Jetslide at all time. A craft left on the Jetslide in a position where the major part of the weight is left on the back, could exert excessive pressure on the back tabs of the Jetslide and **may cause damage which will not be covered by the warranty.**
- 12) The installation of multiple Jetslides side to side is possible, but no rows of cubes should be removed with the aim of saving space moreover the totality of the back Jetslide must be left free to be able to go up and down. Therefore, it must not be connected to the adjacent systems.
- 13) It is normal that a certain wear of the JetSlide appears at the points of contact where the boat exerts more pressure.

### III) ACCESSORIES

#### 1) V PLATE

You'll notice that the installation of in line JetSlides leaves a gap (in red on the attached image) at the V of JetSlide. To fill the gap you must install a V-plate which can be simply screwed under the JetSlide. It is very important for the safety of

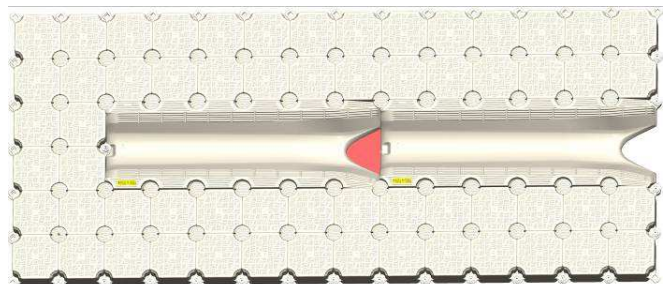

users. Candock Inc. disclaims all liability for accidents if the V plate is not installed.

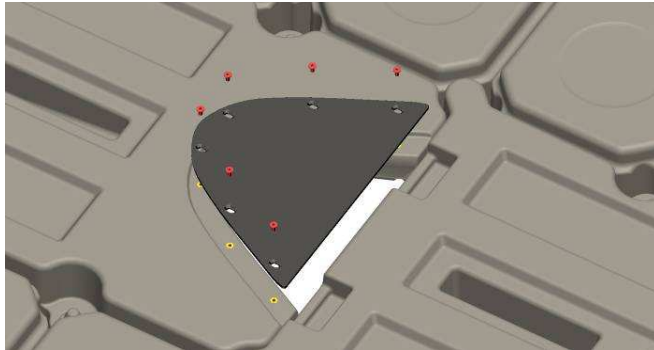

Tighten the 6 screws included with the plate in the inserts for that purpose on the JetSlide.

**BEWARE, THIS PLATE MUST NOT BE INSTALLED ON THE FIRST JETSLIDE BUT FROM THE SECOND.**

## 2) STABILIZER BAR

To stabilize your JetSlide system and minimize the lifting of cubes around the system, a stabilizer bar system was designed.



The positioning of the stabilizer bars is not optional. These should

always be used when recommended and the use of bars other than those provided by Candock is prohibited unless written permission from Candock. The first bar is always installed between the 1st and 2nd row of cubes in the back. The 2nd bar is installed between the 3rd and 4th row of cubes. In order to prevent the lifting of the cubes on the sides, more bars could be required, install them where needed.

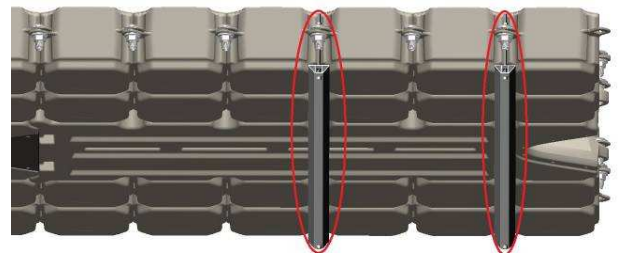

The fixing is done with the hardware kit supplied with the bars. Pass the threaded rode through Candock white bolt and then place the washer, lock washer and nut.

The tightening of the stabilizer bars may exert undue





pressure on the tabs and cause damages to the JetSlide that are not covered by warranties.

### 3) SAFETY PLATE

The half-JetSlide, previously used to supplement the JetSlide for intermediate sizes has been discontinued and was replaced in the G2 line in favor of a Safety Plate available in 3 different sizes. The sizing is based on the extra length that the boat requires.

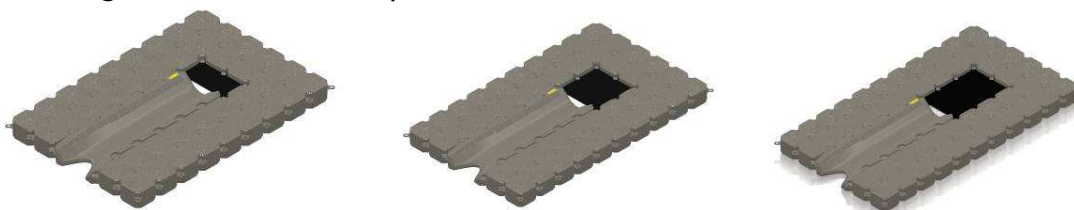

Here are the components necessary for installation\* :

PART NUMBER	DESCRIPTION	SAFETY PLATE 1 CUBE	SAFETY PLATE 2 CUBES	SAFETY PLATE 3 CUBES
CD075	SAFETY PLATE 1 CUBE	1	N/A	N/A
CD076	SAFETY PLATE 2 CUBES	N/A	1	N/A
CD077	SAFETY PLATE 3 CUBES	N/A	N/A	1
LK 703016	SPACER CANDOCK	4	6	8
LK 703013	BLACK SLIDING NUT	5	7	9
LK 703015JETSLIDE	JETSLIDE BOLT	5	7	9

\*According to an independent installation with plugs forward.

#### Installation Steps :

- 1 - Place sliding nut on cube tabs.
- 2 - Place spacers on cube tabs to equalize the height with the highest cube tab.
- 3 - Put the security plate without moving the spacers.
- 4 - Screw JetSlide Bolt on the fixation tab of the safety plate.

In use, the plate can deform slightly and keep this deformation. This deformation is expected and normal.

Please note that the surface of the safety plate can be slippery.

#### 4) PNEUMATIC AIR ASSISTED SYSTEM : AIR ASSIST.

For all boats over 1360kg / 3000lbs, a pneumatic assistance system is requested to ensure proper dry docking of your boat.

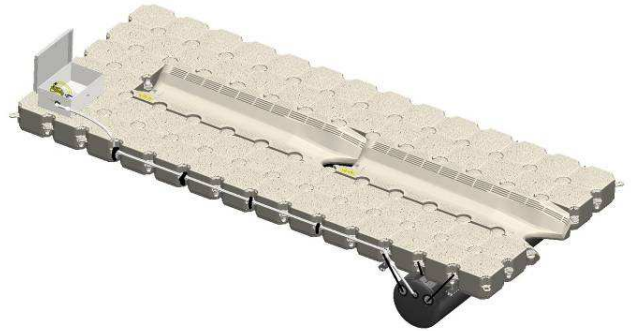

#### 5) WINCH SYSTEM

Sometimes, for a boat less than 1360kg / 3000lbs, a winch may be required to return the boat afloat.

This winch is composed of a pulley and a fixing ring attaching to the side of the dock system as shown in the photo:

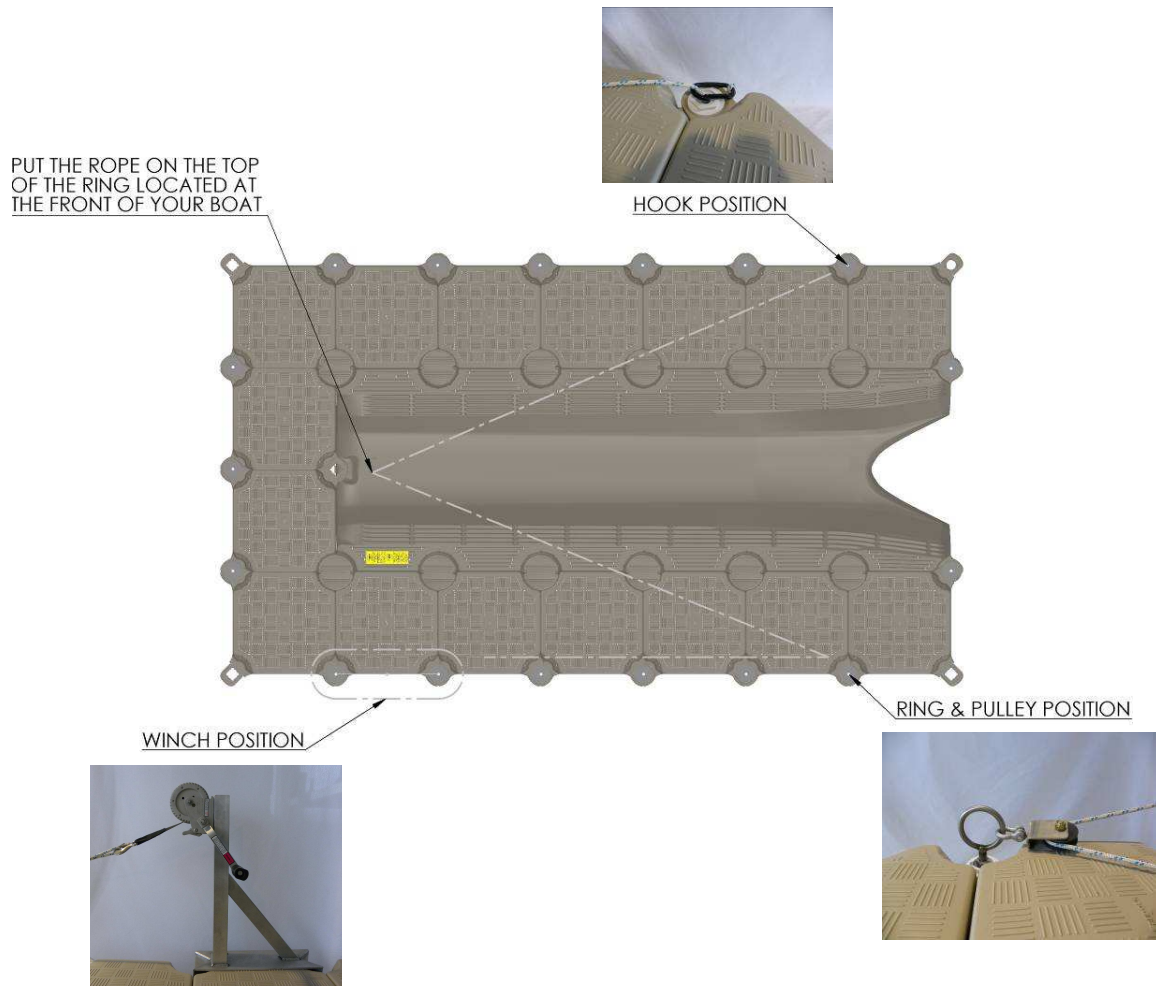

Turn the handle of the winch until the boat is enough in the water that it can back off on its own power. **Do not back the boat too much; it could slide in the water by itself.**



## IV) WARRANTY

Your Jetslide unit carries a 5 years limited warranty as stated below:

**This warranty only applies for Jetslides purchased after april 1<sup>st</sup> 2011**

**This warranty will only apply if your Jetslide configuration has been approved by the Candock head office. For more information: [candock@candock.com](mailto:candock@candock.com)**

### LIABILITY LIMITATION AND WARRANTY DOCUMENT

#### GENERAL

Module docking systems supplied under this warranty are manufactured from the best quality materials and are warranted by CANDOCK Inc., the manufacturer, to the original purchaser against defects in materials and workmanship, as specified under this limited warranty, occurring as a result of the manufacturing process during the stated time period, under normal use and service, subject to the terms and conditions contained in this 5 years limited warranty.

The CANDOCK warranty is strictly subject to the conditions set forth below which form an integral part hereof.

1. The CANDOCK warranty applies to the product being used exclusively for its intended purpose, being a modular drive-on system for boats and watercrafts.
2. The CANDOCK warranty does not apply when a defect or breakage (damage) to the product results from the use of improperly or recklessly operated equipment.
3. The CANDOCK warranty does not extend or apply to:
  - a) normal wear;
  - b) any product damaged as a result of accident, fire, flood or unforeseeable act;
  - c) damage caused by frost, ice or glass, sharp objects such as stone;
  - d) any products repaired or modified or attempted to have been repaired or modified by any person other than a duly authorized representative;
  - e) The installation of CANDOCK products.
4. **THE CANDOCK WARRANTIES SET FORTH HEREIN ARE IN LIEU OF ALL OTHER WARRANTIES, EXPRESS OR IMPLIED, INCLUDING, WITHOUT LIMITATION, ANY WARRANTIES OF MERCHANTABILITY OR FITNESS FOR A**



**PARTICULAR PURPOSE, AND SHALL BE THE SOLE AND EXCLUSIVE REMEDY AVAILABLE TO ORIGINAL PURCHASERS OF CANDOCK MANUFACTURED PRODUCTS.** CANDOCK neither assumes nor incurs any other obligation or liability for the condition of CANDOCK manufactured products, nor authorizes any other party to assume any such obligation or liability on its behalf or to make representations as to the CANDOCK warranty.

- 5. IN NO EVENT SHALL CANDOCK BE LIABLE FOR ANY SPECIAL, INCIDENTAL, OR CONSEQUENTIAL DAMAGES (INCLUDING, WITHOUT LIMITATION, LOST REVENUES AND PROFITS, EVEN IF IT HAS BEEN ADVISED OF THE POSSIBILITY OF SUCH DAMAGES), SUFFERED OR INCURRED BY THE PURCHASER AS A RESULT OF OR IN CONNECTION WITH THE USE OF CANDOCK PRODUCTS.**

## **5 YEARS LIMITED WARRANTY**

### **COVERAGE**

Any defect in material and workmanship from normal Jetslide use under calm water conditions. Any damages due to misuse of the product is not covered under this warranty.

The warranty applies only to the basic product (Jetslide itself).

### **DURATION**

**5 years** and it applies only to the original owner.

This warranty is regressive and it will apply at the following percentages through time:

0-1 year :	100%
1-2 years :	100%
2-3 years :	70%
3-4 years :	40%
4-5 years :	20%
More than 5 years :	0%



## **HOW THE WARRANTY IS APPLIED**

If your Jetslide product is defective we will repair it, or at our choice, replace it at no charge to you. If we decide to repair your product, we may use new or reconditioned replacement parts. If we choose to replace your Jetslide product, we may replace it with a new or reconditioned product of the same or similar design.

## **LIMITATIONS**

*CANDOCK INC. WILL NOT PAY OR BE HELD RESPONSIBLE FOR: INJURIES, LOSS OF TIME; INCONVENIENCE; LOSS OF USE OF YOUR CANDOCK PRODUCT OR PROPERTY DAMAGE CAUSED BY YOUR CANDOCK PRODUCT OR ITS FAILURE TO WORK; ANY SPECIAL, INCIDENTAL OR CONSEQUENTIAL DAMAGES; OR ANY DAMAGES RESULTING FROM MISUSE OR MODIFICATION OF YOUR CANDOCK PRODUCT.*

**Warranty will be void if Candock inc. does not receive this warranty certificate signed by client within 30 days after date of purchase, as well as a picture confirming the proper installation of the product.**

## **RECLAMATIONS**

For warranty service for your Jetslide product, you must provide proof of the date and place of purchase of the product our head office. The defective Jetslide must not be uninstalled before you contact us. We need to get clear pictures of the defective Jetslide in the dock assembly and others showing the problem with precise information on what has occurred. We will also need the serial number if present.

Be sure to include your name, address, telephone number and a description of the operating problem. After repairing, or at our option, replacing your Jetslide product, we will ship it to your home at no cost to you for parts and labour. (exceptions might apply)

This warranty is the only one we will give you on your Jetslide product, and it sets forth all our responsibilities regarding your Jetslide product. There are no other express warranties.

**Candock Inc.  
9441, Bourque  
Deauville, Quebec  
Canada  
J1N 3G1**





**Tel.: (819) 847-2599**

**(888) 547-2599**

**Fax: (819) 847-3250**

[candock@candock.com](mailto:candock@candock.com)

[www.candock.com](http://www.candock.com)

ANNEXE A :

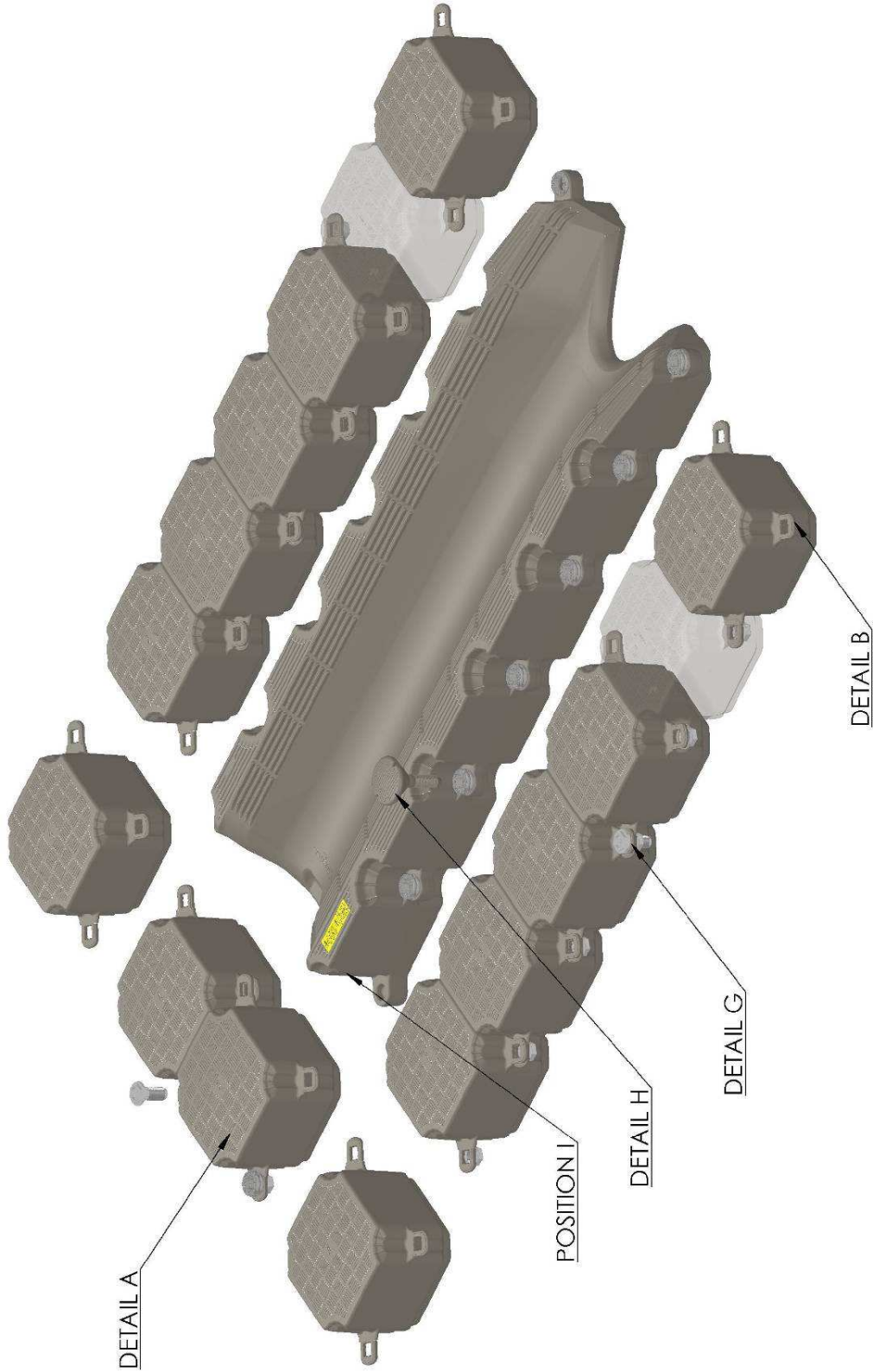

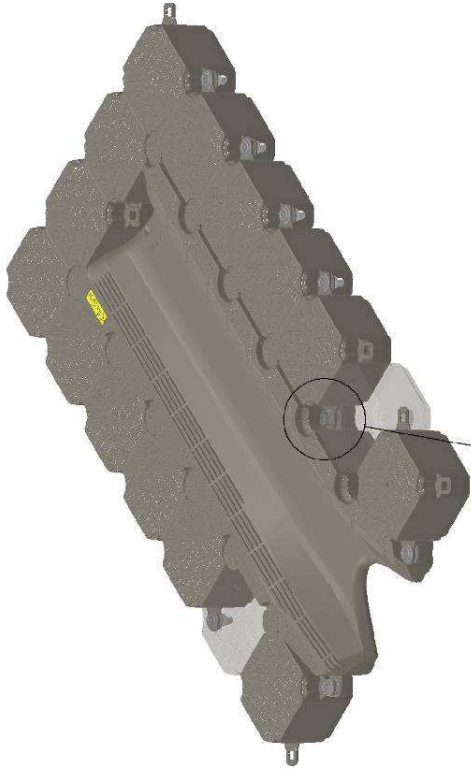

**DETAIL D**  
 TAB IDENTIFICATION NUMBER

**DETAIL F**  
 2 SPACERS

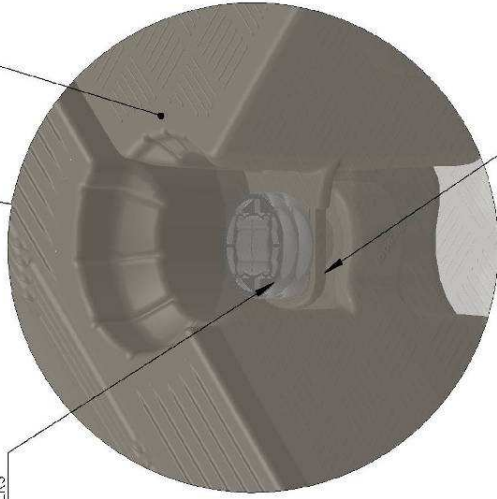

**DETAIL C**  
 CUBETABS ALWAYS COVER THE JETSLIDE TAB

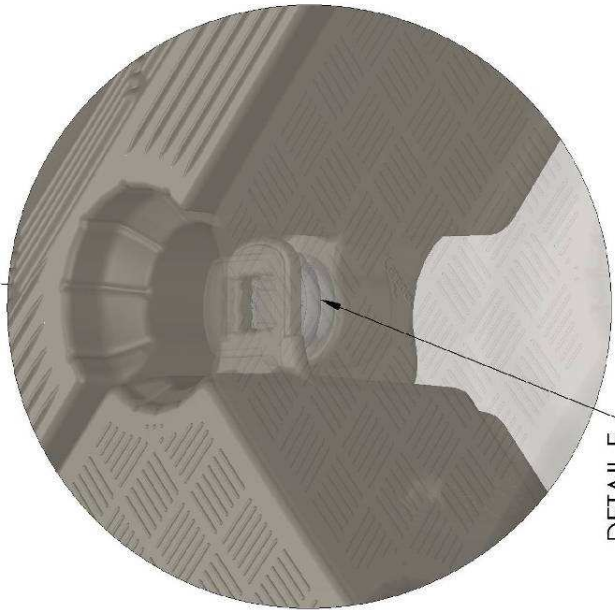
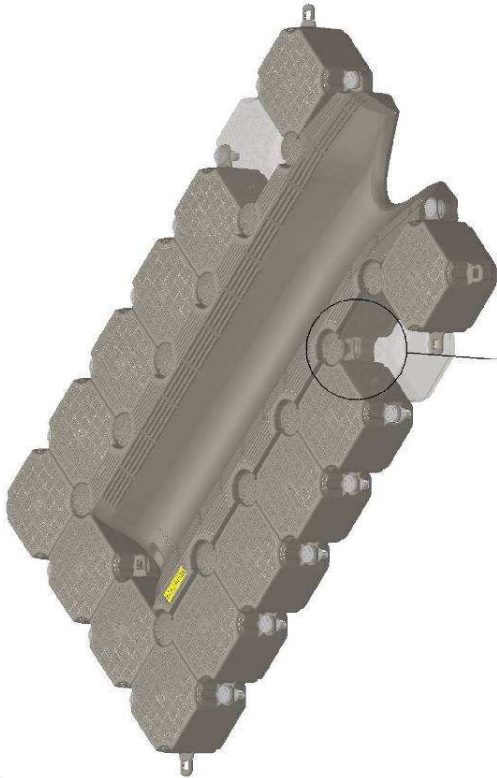

**DETAIL E**  
 2 SPACERS

ANNEXE B :



2 PILINGS

DETAIL K :



4 PILINGS

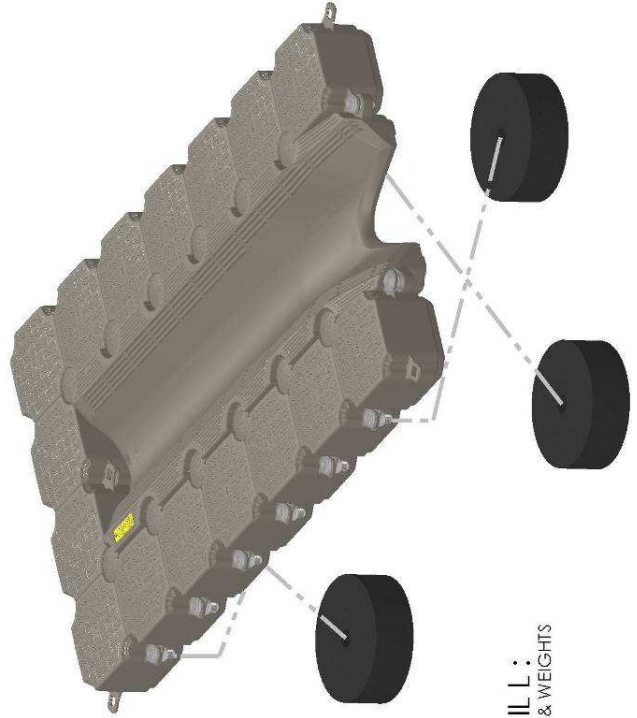

DETAIL L :  
CHAINS & WEIGHTS